

LINEAR VERTICAL HYDRONIC RADIATORS

MANUFACTURED BY:



De Longhi Linear Vertical radiators come in various heights and widths, with a sleek streamlined finish they offer options if space is a problem or if an architectural look is preferred.

Sleek, smooth contemporary looks, with space saving options.



30 YEAR*
WARRANTY

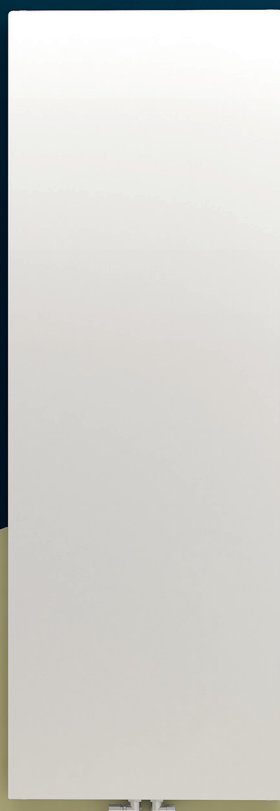

FINISHES

High gloss white.

COLOUR

Standard white - RAL 9016.

MEASUREMENTS

Available in 1400, 1600, 1800, 2000, 2200 and 2400 high.

CENTRE CONNECTION (OPTIONAL)



TOP GRILLE



MELBOURNE

Head Office & Showroom
11 Fiveways Blvd
Keysborough VIC 3173
P: 1300 001 800

SYDNEY

Showroom & Warehouse
Unit G7, Alexandria Industrial Estate
35-39 Bourke Road, Alexandria NSW 2015
P: 02 7209 6235



enquiries@huntheat.com.au



huntheat.com.au

Tables based on ΔT 60°C - mean water temperature in radiator of 80°C and room temperature of 20°C.
Radiator outputs to EN442 Standard.

| Type 10 Single (no side panels, grilles or convection fins) | | | | | | | |
|---|------|-------|-------|-------|-------|-------|-------|
| L-mm | H-mm | 1400 | 1600 | 1800 | 2000 | 2200 | 2400 |
| 300 | kW | 0.477 | 0.525 | 0.584 | 0.645 | 0.720 | 0.797 |
| 400 | kW | 0.636 | 0.700 | 0.779 | 0.859 | 0.961 | 1.063 |
| 500 | kW | 0.795 | 0.825 | 0.973 | 1.074 | 1.201 | 1.328 |
| 600 | kW | 0.954 | 1.050 | 1.168 | 1.289 | 1.441 | 1.594 |
| 700 | kW | 1.113 | 1.225 | 1.363 | 1.504 | 1.681 | 1.860 |
| 900 | kW | 1.431 | 1.576 | 1.752 | 1.934 | 2.161 | 2.391 |

| Type 20 Compact side panels, grilles (no convection fins) | | | | | | | |
|---|------|-------|-------|-------|-------|-------|-------|
| L-mm | H-mm | 1400 | 1600 | 1800 | 2000 | 2200 | 2400 |
| 300 | kW | 0.725 | 0.819 | 0.919 | 1.023 | 1.135 | 1.208 |
| 400 | kW | 0.967 | 1.091 | 1.226 | 1.365 | 1.514 | 1.611 |
| 500 | kW | 1.208 | 1.364 | 1.532 | 1.706 | 1.892 | 2.014 |
| 600 | kW | 1.450 | 1.637 | 1.838 | 2.047 | 2.271 | 2.417 |
| 700 | kW | 1.692 | 1.910 | 2.145 | 2.388 | 2.649 | 2.819 |
| 900 | kW | 2.175 | 2.456 | 2.758 | 3.070 | 3.406 | 3.625 |

| Type 21 Compact side panels, grilles & convection fins | | | | | | | |
|--|------|-------|-------|-------|-------|-------|-------|
| L-mm | H-mm | 1400 | 1600 | 1800 | 2000 | 2200 | 2400 |
| 300 | kW | 0.936 | 1.029 | 1.120 | 1.205 | 1.286 | 1.426 |
| 400 | kW | 1.248 | 1.372 | 1.493 | 1.607 | 1.714 | 1.901 |
| 500 | kW | 1.560 | 1.715 | 1.867 | 2.009 | 2.143 | 2.376 |
| 600 | kW | 1.872 | 2.059 | 2.240 | 2.410 | 2.572 | 2.851 |
| 700 | kW | 2.184 | 2.402 | 2.614 | 2.812 | 3.000 | 3.357 |
| 900 | kW | 2.807 | 3.088 | 3.360 | 3.616 | 3.857 | 4.277 |

| Type 22 Double side panels, grilles & convection fins | | | | | | | |
|---|------|-------|-------|-------|-------|-------|-------|
| L-mm | H-mm | 1400 | 1600 | 1800 | 2000 | 2200 | 2400 |
| 300 | kW | 1.194 | 1.317 | 1.441 | 1.553 | 1.712 | 1.868 |
| 400 | kW | 1.591 | 1.756 | 1.978 | 2.072 | 2.293 | 2.491 |
| 500 | kW | 1.990 | 2.196 | 2.402 | 2.590 | 2.867 | 3.113 |
| 600 | kW | 2.387 | 2.635 | 2.882 | 3.107 | 3.441 | 3.622 |
| 700 | kW | 2.786 | 3.073 | 3.363 | 3.626 | 4.015 | 4.358 |
| 900 | kW | 3.581 | 3.952 | 4.323 | 4.662 | 5.162 | 5.605 |

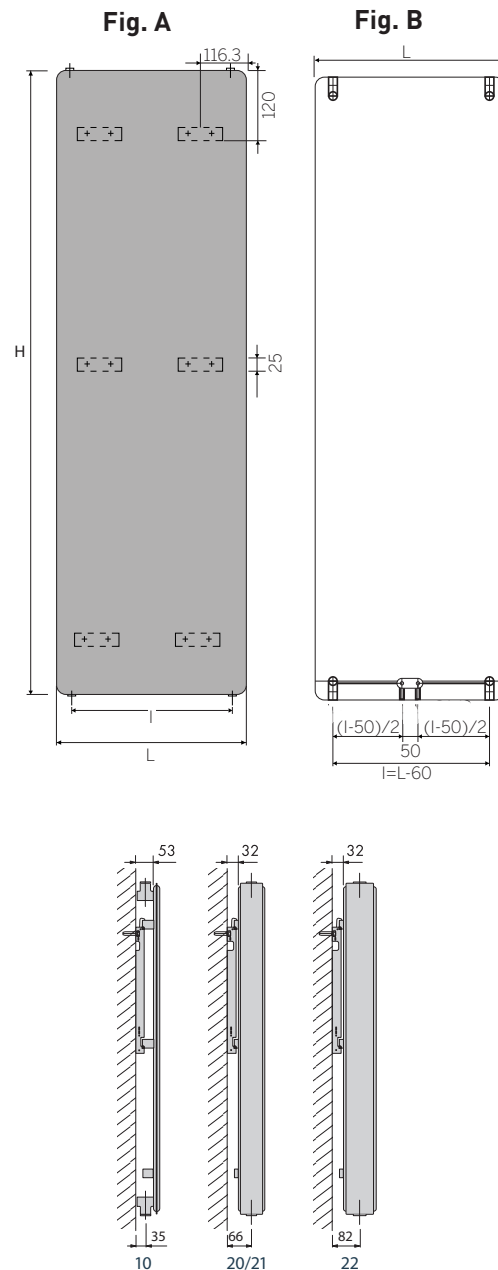

CONNECTION OPTIONS:

Bottom valve connections to either side of the radiator as standard, refer to above diagram A. The connection centres are 30mm in from each outside edge of the radiator. Take the radiator width "L" then deduct 60mm to get pipe centres "I" measurement. Centre connection option refer to above diagram B. Take the radiator width "L" deduct 50mm then divide by 2 to get pipe centre measurements from edge of radiator.

Instructions for placement of noggins for Delonghi linear vertical radiators.

Suggested size for noggins; 90mm x 40mm framing timber installed vertically to either side of the radiator and set in 116mm from side of radiator. This will ensure you have suitable fixing for brackets.

NOTE: All measurements shown on diagrams in millimeters (not to scale).

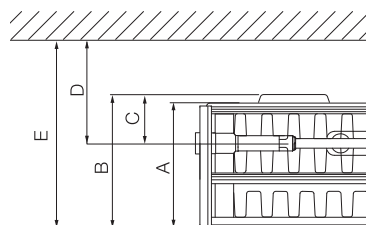

| | | 10 | 20 | 21 | 22 |
|---|---|----|--------|--------|---------|
| panel depth excluding back supports | A | 62 | 70 | 70 | 102 |
| total depth - from the back of the support to the front panel | B | 62 | 77 | 77 | 111 |
| distance from the back support to the connection | C | - | 43 | 43 | 60 |
| distance from wall to the centre of the connection | D | 35 | 58/66 | 58/66 | 74/82 |
| total distance from the wall to the front panel | E | 70 | 93/101 | 93/101 | 125/133 |